

Stan

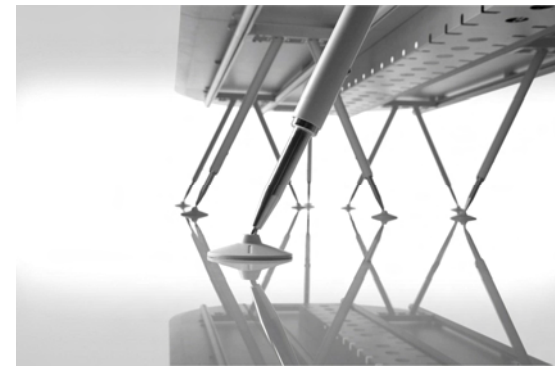

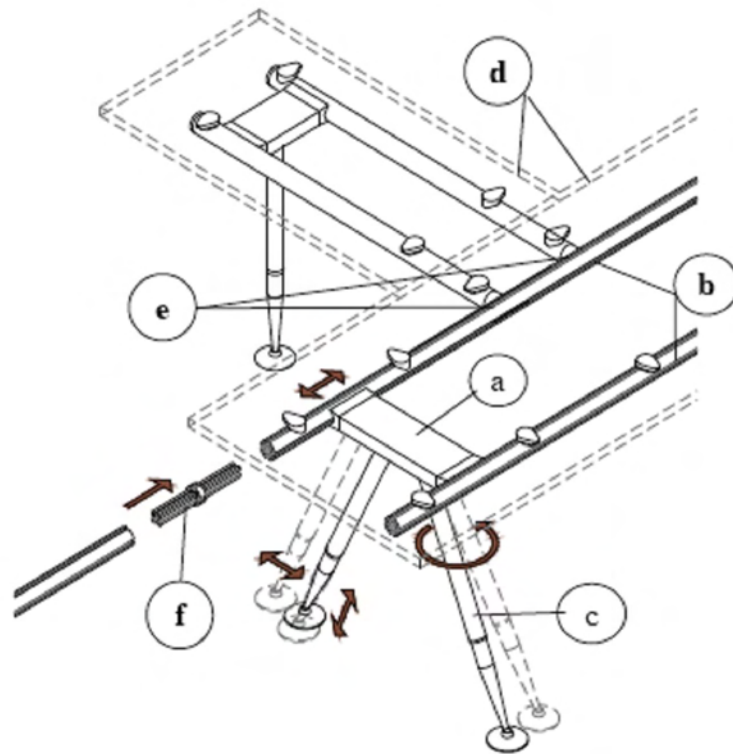



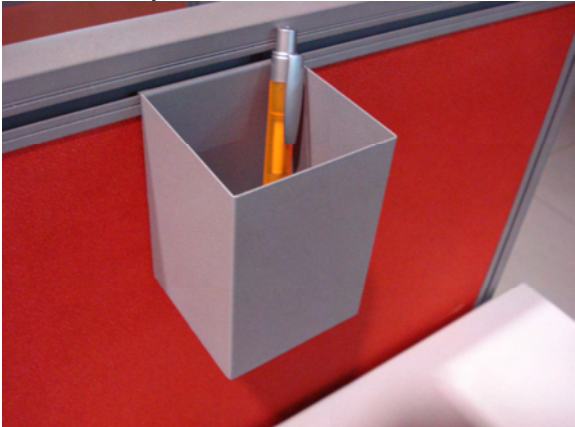

Diagram 1.0

<p>1. Understructure</p>	
<p>1.1 Legs</p>	<ul style="list-style-type: none"> • A_leg (Diagram 1.0 'c'): The A_leg is made of a round mild steel tube Ø38mm with a solid milled out rod extension in chrome which can provide adjustment (690mm – 750mm in height) • Die cast aluminum floor glide Ø 80mm • Material: Round mild steel tube with steel plate, solid milled rod and Aluminum die cast glide
<p>1.2 Support Beam</p>	<ul style="list-style-type: none"> • Extrude aluminum profile support beam (Diagram 1.0 'b') is Ø 50mm. • Beam lengths from 600mm – 2400mm long can be specified. • Material: Extrude aluminum profile

<p>1.3 Bridge (200mm / 350mm / 450mm)</p>	<ul style="list-style-type: none"> • The bridge (Diagram 1.0 'a') connects the support beams which run parallel to one another. The bridge can be placed anywhere along the main support beams and can be used for a number of different leg positions or extensions. • Material: Extrude aluminum profile and die cast
<p>1.4 Power Coating</p>	<ul style="list-style-type: none"> • Thickness – 60 micron of epoxy powder coat from JOTUN • The surface treatment is epoxy powder coat which be classified as not ecotoxic. All Stan product is epoxy powder coat source from Jotun. • Jotun, (www.jotun.com.my) is certified in two categories: Quality management systems (ISO 9001/9002/9003) and Environmental management systems (ISO 14001) • Scratch test – Please refer to Jotun website
<p>1.4.1 Chrome</p>	<ul style="list-style-type: none"> • Thickness – 15 micron of Chromium • Scratch test – Scratch resistance
<p>1.5 Warranty</p>	<ul style="list-style-type: none"> • 10 years warranty (Please refer to attachment <i>Manufacturer Warranty – Stan understructure</i>)
<p>2. Worktop</p>	
<p>2.1 Particle board thickness & brand</p>	<ul style="list-style-type: none"> • TAZ source all MFC (18mm & 25mm) products from Mieco Chipboard Sdn Bhd - www.mieco.com.my. Usage of E1 equivalent tops to minimise the chances of high level chemical burning and contains low formaldehyde emission chipboard. • Mieco has attained the prestigious BS EN ISO 14001: 1996 Environmental Managements System accredited by Lloyd's Register Quality Assurance. (http://www.mieco.com.my/e_iso14001.htm) • Density (substrate) : 680 ± 20kg/m³ (refer to <i>Mieco Substrate Spec.pdf</i>)
<p>2.2 Table Edgebanding</p>	<ul style="list-style-type: none"> • Edging source from Doelken. 2mm PVC matching color edging. (http://www.doellken-woodtape.com/products/pvc-edgebanding/)

<p>2.3 Loading bearing capacity</p>	<ul style="list-style-type: none"> • (Please refer to attachment <i>Mieco D_MFC Spec.pdf</i>) • For understructure (Stan) - Please refer to 'Testing' Section under 6. Miscellaneous
<p>3. Cable Hatch/ Tray</p>	<div style="text-align: center;">   </div> <p>Note: Cable tray can hold up to 30 cables of Cat 5 & 6 by laying it on the tray.</p>
<p>3.1 Thickness/ material</p>	<ul style="list-style-type: none"> • Material: 1.0mm sheet metal (cable tray) & aluminum extrude (cable hatch) • 60 micron epoxy powder coat

4. Accessories	
4.1 Lighting	<ul style="list-style-type: none">• Lighting: 
4.2 Work tools Organizer	<ul style="list-style-type: none">• Paper tray  Material: Sheet Metal• Pencil Tray  Material: Sheet Metal

4.3 CPU

- Trolley (mobile)

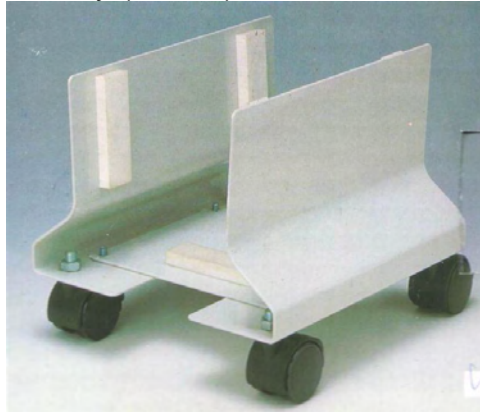

Material: Sheet metal

- Fixed (under worktop)



<p>5. Pedestal</p>	
<p>5.1 Pedestal Lock</p>	 <ul style="list-style-type: none"> • MFC-based & Metal-based pedestal: Cyber lock locking system (http://www.cyber-lock.com/about.html) • 1-2000 lock combination • Provide master key • Key alike & core removable function • “Inter Lock” safety device – prevents drawers being opened when one is already open.
<p>5.2 Drawer sliders</p>	<ul style="list-style-type: none"> • http://www.repon.com.tw/en/ab_profile.html Italian ball bearing slide for 30 years (made in Taiwan) • Repon quality system certified: ISO 9002 in 1996 QS 9000 in 2001 ISO 9000:2000 in 2005 http://www.repon.com.tw/en/ab_promise.html
<p>5.3 Casters</p>	<ul style="list-style-type: none"> • Jenp Jou – Leading manufacturer and exporter of Twin Wheel Casters, Single Wheels. Establish in 1992 and obtain ISO 9001:2000. • Apart from the durability test equipments specified in ANSI BIFMA/ JIS/ DIN/ FIRA, Jenp Jou also designed and purchased other test equipments to reinforce the quality of our products. With continuous improvement of their

	<p>quality, selection of materials and management system.</p> <ul style="list-style-type: none"> • Wheel - Ø 40mm • Loading Capacity: 30kg (each) <p>(Please refer to <i>Casters_Jenp Jou certificate.pdf</i>)</p>
<p>6. Miscellaneous</p>	
<p>Testing</p>	<p>Stan desking has comply with BS 4875-5:2001: Test Level 4: According to the Standards this product is therefore considered to be structurally suitable and sufficiently stable for * General Contract use.</p> <p>Tested description are:</p> <ul style="list-style-type: none"> • Stability under vertical load, test force, V1 300Nm V2 600N • Stability –Horizontal impact , drop height, 45mm • Horizontal static load, test force 600 N • Vertical static load, test force, a) main working surface 1250N, ancillary working surface 500N • Horizontal fatigue, 30000 number of cycles: test force 150N • Vertical fatigue for cantilevered table, 30000 number of cycles, test force 300N • Sustained load, test load, 200kg/m2 • Vertical impart, drop height 240mm • Drop test for single, 300 mm <p>FIRA Certificate reference: TFRIM0070</p>
<p>Consumption Recycling</p>	<p>Recovery and recycling. Assembly and disassembly of the product is relatively straight forward and the manufacturer had made commitment to the recovery and re-use of the product range.</p>
<p>Product Custodianship</p>	<p>TAZ Corporation has establishes a market take back policy for the product range at end of life.</p>