

# Stan



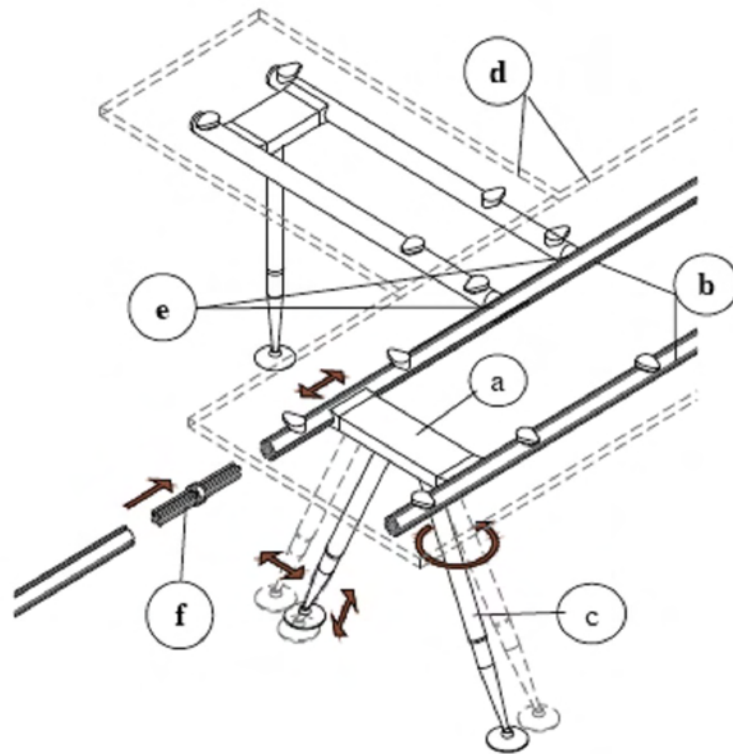



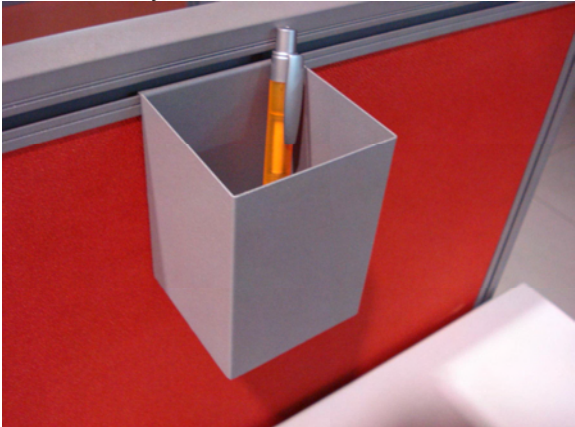

Diagram 1.0

<p><b>1. Understructure</b></p>	
<p><b>1.1 Legs</b></p>	<ul style="list-style-type: none"> <li>• <b>A_leg</b> (Diagram 1.0 'c'): The A_leg is made of a round mild steel tube Ø38mm with a solid milled out <b>rod extension</b> in chrome which can provide adjustment (690mm – 750mm in height)</li> <li>• Die cast aluminum floor <b>glide</b> Ø 80mm</li> <li>• Material: Round mild steel tube with steel plate, solid milled rod and Aluminum die cast glide</li> </ul>
<p><b>1.2 Support Beam</b></p>	<ul style="list-style-type: none"> <li>• Extrude aluminum profile <b>support beam</b> (Diagram 1.0 'b') is Ø 50mm.</li> <li>• Beam lengths from 600mm – 2400mm long can be specified.</li> <li>• Material: Extrude aluminum profile</li> </ul>

<p><b>1.3 Bridge (200mm / 350mm / 450mm)</b></p>	<ul style="list-style-type: none"> <li>• The <b>bridge</b> (Diagram 1.0 'a') connects the support beams which run parallel to one another. The bridge can be placed anywhere along the main support beams and can be used for a number of different leg positions or extensions.</li> <li>• Material: Extrude aluminum profile and die cast</li> </ul>
<p><b>1.4 Power Coating</b></p>	<ul style="list-style-type: none"> <li>• Thickness – 60 micron of epoxy powder coat from JOTUN</li> <li>• The surface treatment is epoxy powder coat which be classified as not ecotoxic. All Stan product is epoxy powder coat source from Jotun.</li> <li>• Jotun, (<a href="http://www.jotun.com.my">www.jotun.com.my</a>) is certified in two categories: Quality management systems (ISO 9001/9002/9003) and Environmental management systems (ISO 14001)</li> <li>• Scratch test – Please refer to Jotun website</li> </ul>
<p><b>1.4.1 Chrome</b></p>	<ul style="list-style-type: none"> <li>• Thickness – 15 micron of Chromium</li> <li>• Scratch test – Scratch resistance</li> </ul>
<p><b>1.5 Warranty</b></p>	<ul style="list-style-type: none"> <li>• 10 years warranty (Please refer to attachment <i>Manufacturer Warranty – Stan understructure</i>)</li> </ul>
<p><b>2. Worktop</b></p>	
<p><b>2.1 Particle board thickness &amp; brand</b></p>	<ul style="list-style-type: none"> <li>• TAZ source all MFC (18mm &amp; 25mm) products from Mieco Chipboard Sdn Bhd - <a href="http://www.mieco.com.my">www.mieco.com.my</a>. Usage of E1 equivalent tops to minimise the chances of high level chemical burning and contains low formaldehyde emission chipboard.</li> <li>• Mieco has attained the prestigious BS EN ISO 14001: 1996 Environmental Managements System accredited by Lloyd's Register Quality Assurance. (<a href="http://www.mieco.com.my/e_iso14001.htm">http://www.mieco.com.my/e_iso14001.htm</a>)</li> <li>• Density (substrate) : 680 ± 20kg/m<sup>3</sup> (refer to <i>Mieco Substrate Spec.pdf</i>)</li> </ul>
<p><b>2.2 Table Edgebanding</b></p>	<ul style="list-style-type: none"> <li>• Edging source from Doelken. 2mm PVC matching color edging. (<a href="http://www.doellken-woodtape.com/products/pvc-edgebanding/">http://www.doellken-woodtape.com/products/pvc-edgebanding/</a>)</li> </ul>

<p><b>2.3 Loading bearing capacity</b></p>	<ul style="list-style-type: none"> <li>• (Please refer to attachment <i>Mieco D_MFC Spec.pdf</i>)</li> <li>• For understructure (Stan) - Please refer to '<b>Testing</b>' Section under <b>6. Miscellaneous</b></li> </ul>
<p><b>3. Cable Hatch/ Tray</b></p>	<div style="text-align: center;">     </div> <p>Note: Cable tray can hold up to 30 cables of Cat 5 &amp; 6 by laying it on the tray.</p>
<p><b>3.1 Thickness/ material</b></p>	<ul style="list-style-type: none"> <li>• Material: 1.0mm sheet metal (cable tray) &amp; aluminum extrude (cable hatch)</li> <li>• 60 micron epoxy powder coat</li> </ul>

<b>4. Accessories</b>	
<b>4.1 Lighting</b>	<ul style="list-style-type: none"><li>• Lighting: </li></ul>
<b>4.2 Work tools Organizer</b>	<ul style="list-style-type: none"><li>• Paper tray  Material: Sheet Metal</li><li>• Pencil Tray  Material: Sheet Metal</li></ul>

**4.3 CPU**

- Trolley (mobile)

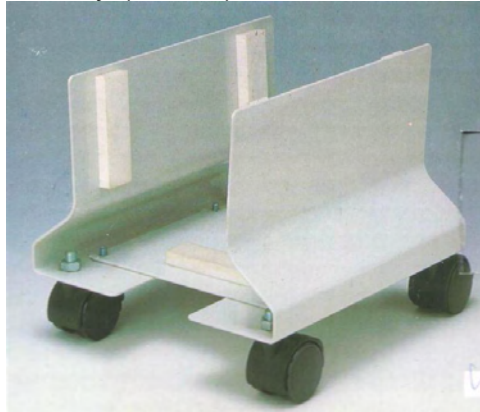

Material: Sheet metal

- Fixed (under worktop)



<p><b>5. Pedestal</b></p>	
<p><b>5.1 Pedestal Lock</b></p>	 <ul style="list-style-type: none"> <li>• MFC-based &amp; Metal-based pedestal: Cyber lock locking system (<a href="http://www.cyber-lock.com/about.html">http://www.cyber-lock.com/about.html</a>)</li> <li>• 1-2000 lock combination</li> <li>• Provide master key</li> <li>• Key alike &amp; core removable function</li> <li>• “Inter Lock” safety device – prevents drawers being opened when one is already open.</li> </ul>
<p><b>5.2 Drawer sliders</b></p>	<ul style="list-style-type: none"> <li>• <a href="http://www.repon.com.tw/en/ab_profile.html">http://www.repon.com.tw/en/ab_profile.html</a> Italian ball bearing slide for 30 years (made in Taiwan)</li> <li>• Repon quality system certified:  ISO 9002 in 1996 QS 9000 in 2001 ISO 9000:2000 in 2005  <a href="http://www.repon.com.tw/en/ab_promise.html">http://www.repon.com.tw/en/ab_promise.html</a></li> </ul>
<p><b>5.3 Casters</b></p>	<ul style="list-style-type: none"> <li>• Jenp Jou – Leading manufacturer and exporter of Twin Wheel Casters, Single Wheels. Establish in 1992 and obtain ISO 9001:2000.</li> <li>• Apart from the durability test equipments specified in ANSI BIFMA/ JIS/ DIN/ FIRA, Jenp Jou also designed and purchased other test equipments to reinforce the quality of our products. With continuous improvement of their</li> </ul>

	<p>quality, selection of materials and management system.</p> <ul style="list-style-type: none"> <li>• Wheel - Ø 40mm</li> <li>• Loading Capacity: 30kg (each)</li> </ul> <p>(Please refer to <i>Casters_Jenp Jou certificate.pdf</i>)</p>
<p><b>6. Miscellaneous</b></p>	
<p><b>Testing</b></p>	<p>Stan desking has comply with BS 4875-5:2001: Test Level 4: According to the Standards this product is therefore considered to be structurally suitable and sufficiently stable for * General Contract use.</p> <p>Tested description are:</p> <ul style="list-style-type: none"> <li>• Stability under vertical load, test force, V1 300Nm V2 600N</li> <li>• Stability –Horizontal impact , drop height, 45mm</li> <li>• Horizontal static load, test force 600 N</li> <li>• Vertical static load, test force, a) main working surface 1250N, ancillary working surface 500N</li> <li>• Horizontal fatigue, 30000 number of cycles: test force 150N</li> <li>• Vertical fatigue for cantilevered table, 30000 number of cycles, test force 300N</li> <li>• Sustained load, test load, 200kg/m2</li> <li>• Vertical impart, drop height 240mm</li> <li>• Drop test for single, 300 mm</li> </ul> <p>FIRA Certificate reference: TFRIM0070</p>
<p><b>Consumption Recycling</b></p>	<p>Recovery and recycling. Assembly and disassembly of the product is relatively straight forward and the manufacturer had made commitment to the recovery and re-use of the product range.</p>
<p><b>Product Custodianship</b></p>	<p>TAZ Corporation has establishes a market take back policy for the product range at end of life.</p>