

Mobile Mounts

Specification

- (1) Height Adjustment (up-down movement) range: 550mm.
- (2) Loading Capacity : Display 25~35kgs.
- (2) meets VESA: 200x200, 400x200, 400x400, 600x400mm.
- (3) base wheels diameter: 3" integrated-molding wheels.
- (4) height adjustment stopper: enabling flexibility of vertically adjusting TV to the best-viewing Height. Ex-factory stopper set at the lowest point of 550mm.

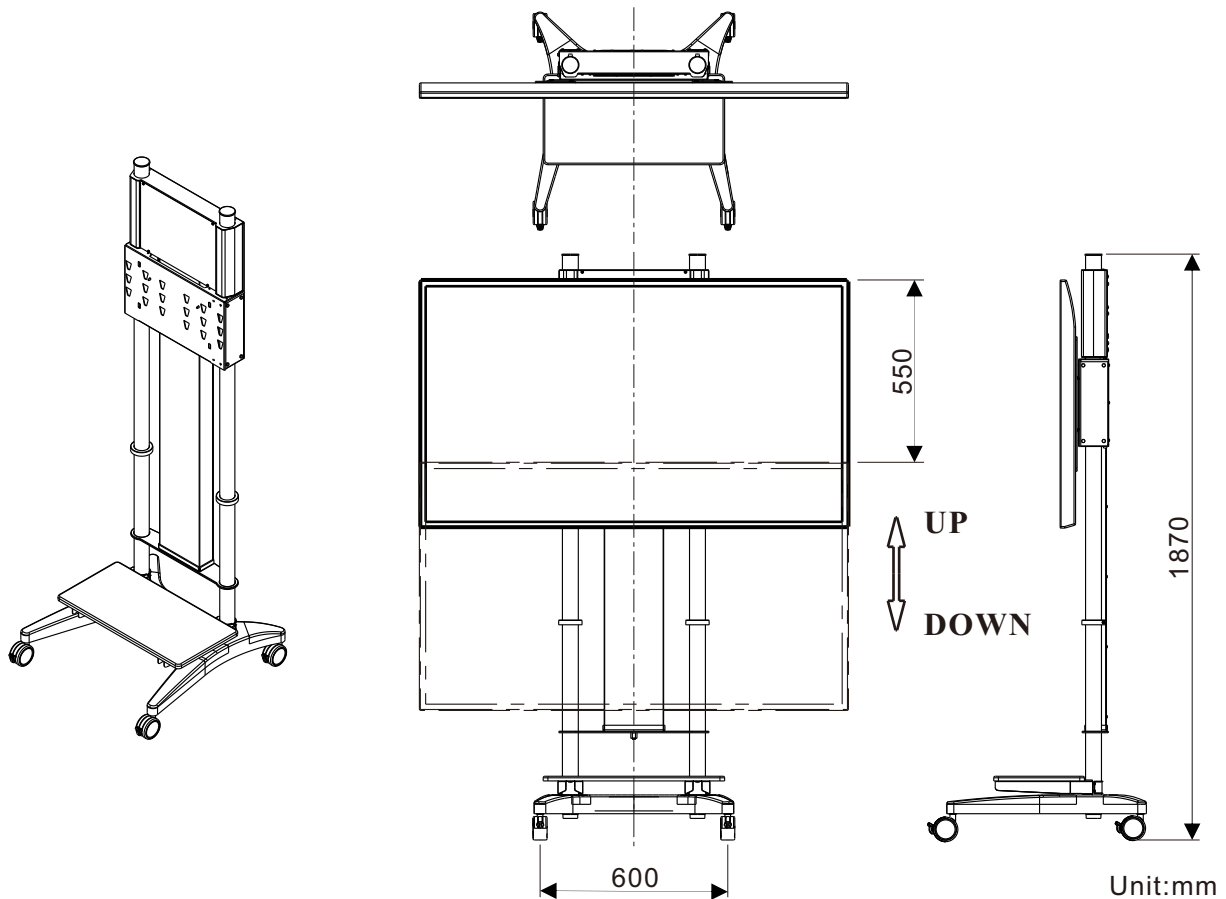

Parts List

MAIN PARTS

ITEM	1	2	3	4	5	6	7	8	9	10	11	12	13
PARTS													
QTY	1	4	1	1	1	2	2	1	2	8	2	4	4

ITEM	14	15	16	17	18
PARTS					
	M6X30	M8X15	M8X40		
QTY	4	4	4	8	8

⚠ Recommend 2-persons to hold the TV and to process the installation.

⚠ Be aware of the specifications and steps indicated on this Brochure.

Mobile Mounts

Installation

I. Insert parts item ② to the holes beneath parts item ① (stand base).

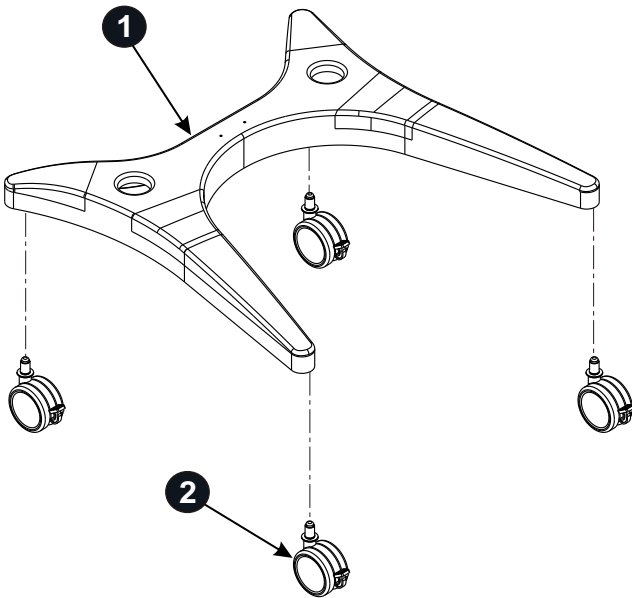

II. As below illustration: Connect the standbody with the base by inserting parts item ③ into item ① .

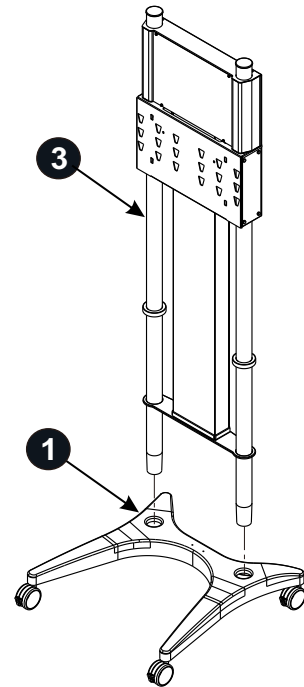

III. Mounting Display on the plate(parts item ④) with screws (parts item ⑬)

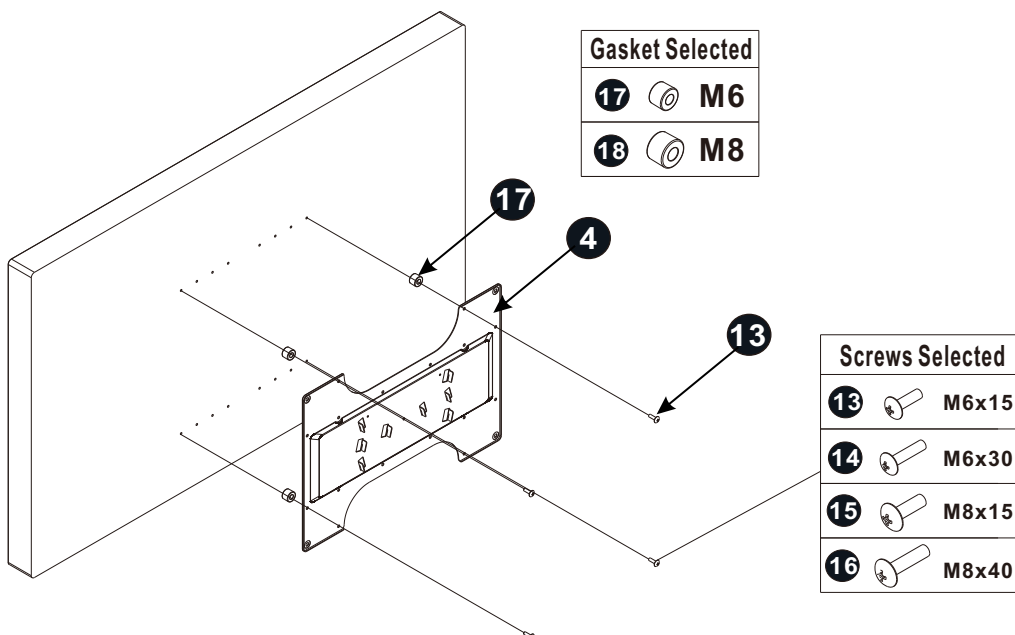

Mobile Mounts

Installation

IV. Hanging Display on the parts item ③ .

※ Please approach the parts item ③ closely and then follow the direction to hook on the display. Make sure the mount plate being plug into the holes on parts item ③ tightly.

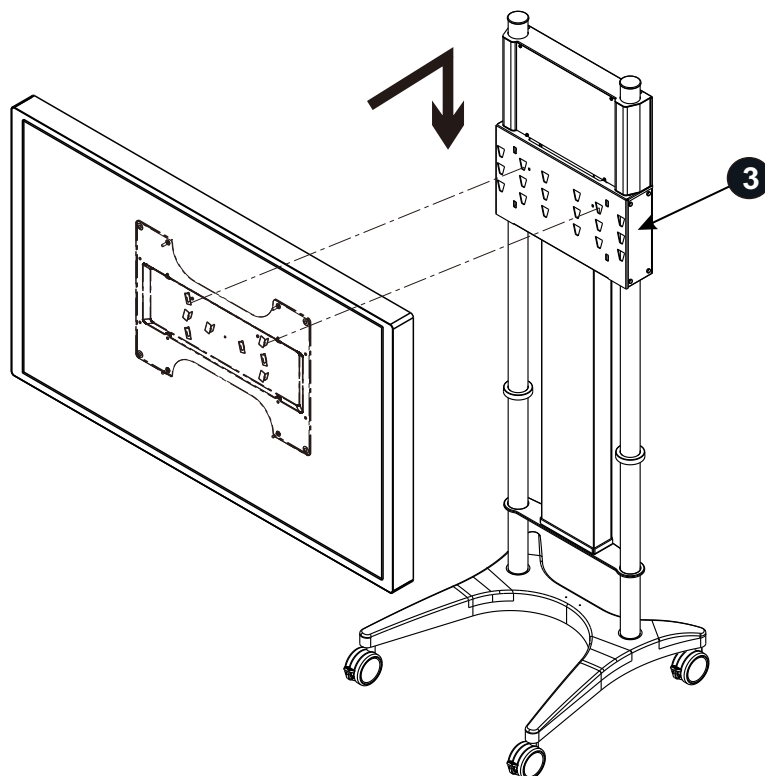

V. Following by step IV, Please screw in the parts item ⑪ to fasten TV and mount bracket.

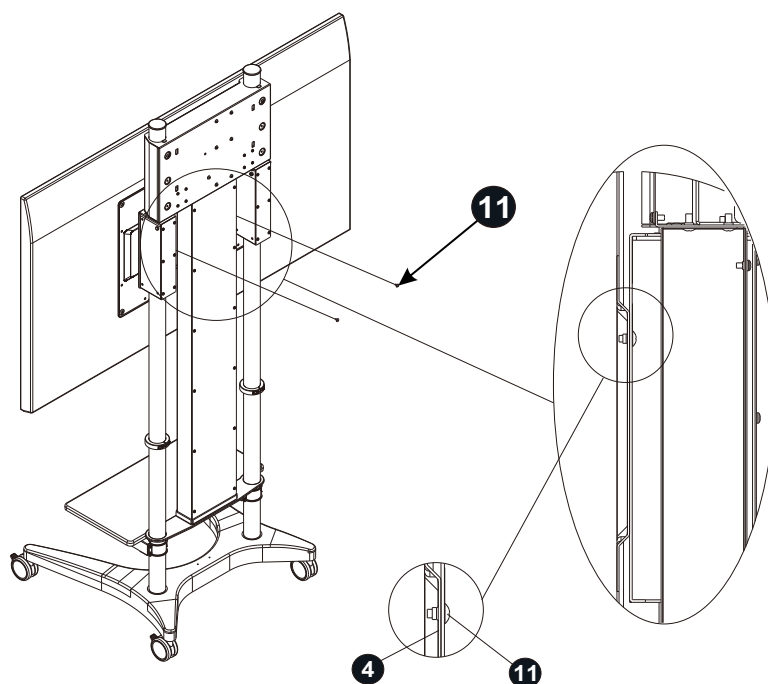

Mobile Mounts

Installation

VI. Adjusting the loading weight according to your display:

For A360MED: Please use parts item ⑧ to adjust the Hex nut underneath the stand body to be well adapted to your Display precise weight. To do the adjustment on this model, only the TV/Display weight between 25~35kgs is allowed. (Original loading default set: 30kgs) For lighter or heavier Display than 30kgs, stand can be adjusted as below illustration.

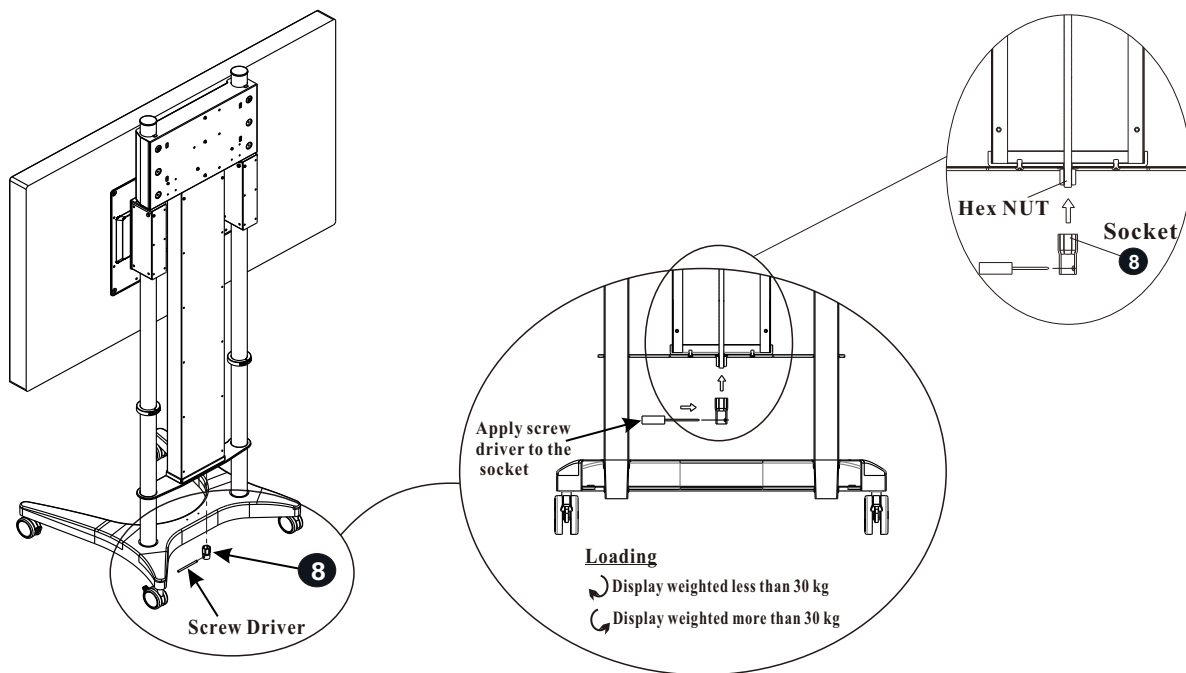

VII. Optional installation: If it is necessary, the commodity wooden shelf can be installed as below.

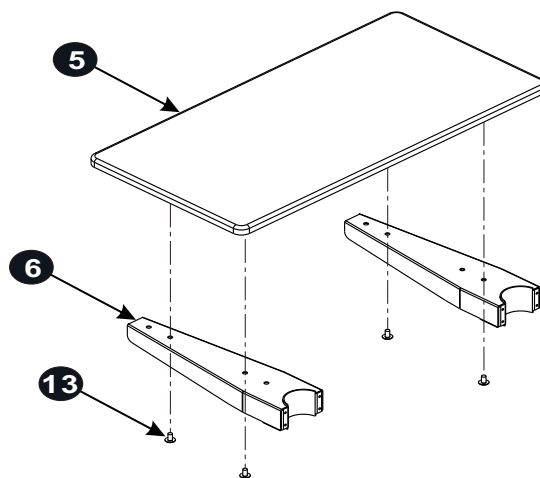

Assemble shelf :
Joint ⑤ and ⑥ with parts ⑬ to fasten.

Mobile Mounts

Installation

VIII. For completing the shelf installation, please use parts item ⑩ to tighten parts ⑦ and parts ⑩.

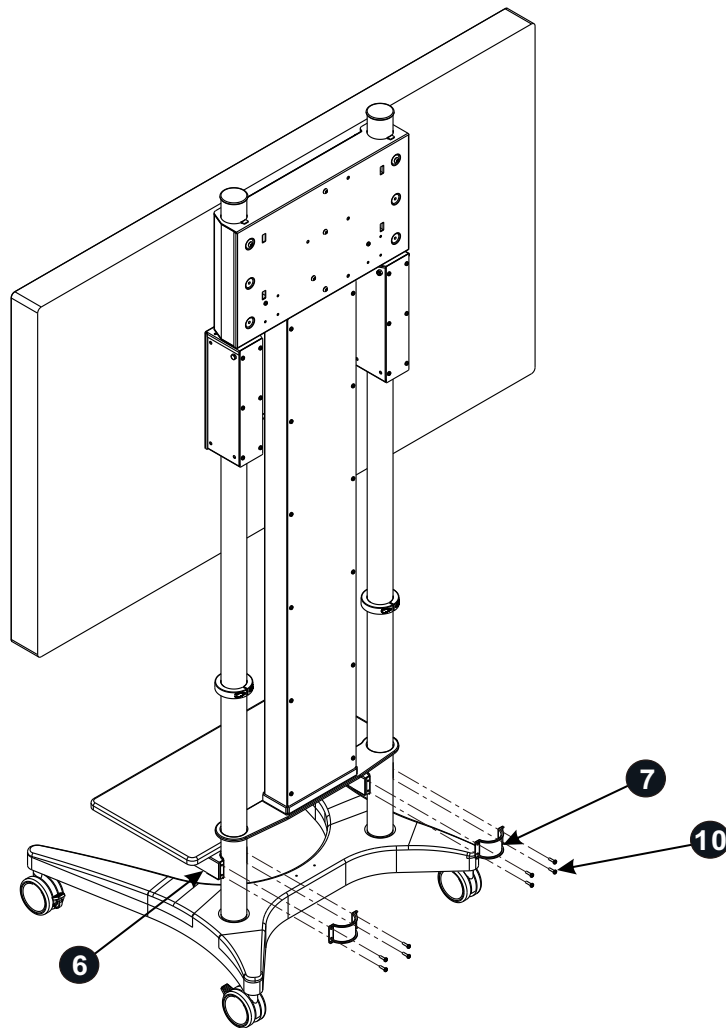

Mobile Mounts

Installation

IX. Managing Cables:

- Moving Display to the highest position
- Managing the cables/wires at the back of display and tap them on the central board of stand. Fasten cables with parts item ⑨ like below.
- To fasten cables: take out any one bolt from 1~6 position; then bend and screw tightly parts ⑨ back to any of 1~6 position.

Note: leave extra cable length when fasten cables with parts ⑨ to enable up-down movement.

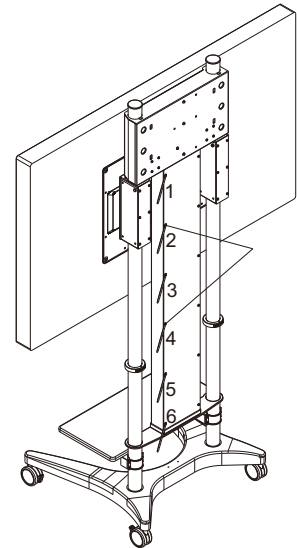

Examples

A	<p>1.1</p> <p>TV at the Top</p>	<p>1.2</p> <p>TV at the Low</p>
B	<p>2.1</p> <p>TV at the Top</p>	<p>2.2</p> <p>TV at the Low</p>

Mobile Mounts

Installation

X. Height Adjustable distance: lowest-to-highest: 550mm

Loosing the screws and nuts on the stoppers and moving it UP to shorten the height adjustable distance. (The original ex-factory set already at the lowest of the Maximum distance 550mm)

